

Wirewound Resistors, Commercial Power, Radial Terminals

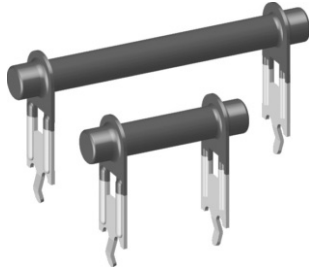

FEATURES

- Direct mounting on printed circuit board
- Circuit board lock-in mounting tabs
- High performance for low cost



RoHS*
COMPLIANT

Please reference the Vishay Dale CPR as an alternative option (for CPR datasheet please visit our website: <http://www.vishay.com/doc?30219>).

STANDARD ELECTRICAL SPECIFICATIONS			
GLOBAL MODEL	POWER RATING $P_{70^\circ\text{C}}$ W	RESISTANCE RANGE Ω	
		$\pm 5\%, \pm 10\%$	
		TCR $\pm 600 \text{ ppm}/^\circ\text{C}$	TCR $\pm 300 \text{ ppm}/^\circ\text{C}$
CPS04	4	R10 - R99	1R0 - 1K0
CPS05	5	R10 - R99	1R0 - 2K0
CPS07	6.5	R10 - R99	1R0 - 2K7

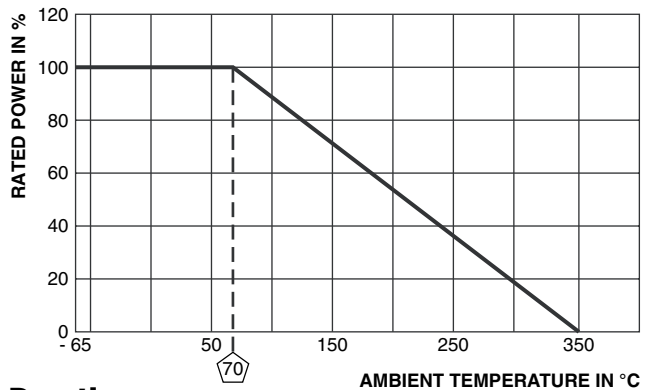

TECHNICAL SPECIFICATIONS		
PARAMETER	UNIT	CPS CHARACTERISTICS
Operating Temperature Range	$^\circ\text{C}$	- 65 to + 350
Short Time Overload	-	5 x rated power for 5 s
Terminal Strength	lb	10 minimum
Maximum Working Voltage	V	$(P \times R)^{1/2}$

PERFORMANCE		
TEST	CONDITIONS OF TEST	TEST LIMITS
Load Life	1000 h at rated power, 1.5 h "ON", 0.5 h "OFF"	$\pm 3.0\% \Delta R$ average
Climatic Sequence	1000 cycles, - 55 $^\circ\text{C}$ to + 125 $^\circ\text{C}$	$\pm 2.0\% \Delta R$
Damp Heat, Steady State	+ 40 $^\circ\text{C}$, 93 % RH, 56 days	$\pm 2.0\% \Delta R$
Resistance to Solder Heat	+ 260 $^\circ\text{C}$, 10 s	$\pm 0.2\% \Delta R$ typical
Low Temperature Operation	- 65 $^\circ\text{C}$, full rated working voltage for 45 min	$\pm 3.0\% \Delta R$

GLOBAL PART NUMBER INFORMATION														
Global Part Numbering Example: CPS05P100R0K E14														
C	P	S	0	5	P	1	0	0	R	0	K	E	1	4
GLOBAL MODEL	TERMINAL	VALUE	TOLERANCE	PACKAGING	SPECIAL									
CPS04 CPS05 CPS07	P = /2	R = Decimal K = Thousand R1500 = 0.15 Ω 1K000 = 1000 Ω	J = $\pm 5.0\%$ K = $\pm 10.0\%$	E14 = Lead (Pb)-free bulk E31 = Lead (Pb)-free four layer bulk B14 = Tin/lead bulk B31 = Tin/lead four layer bulk	(Dash Number) (up to 3 digits) From 1 - 999 as applicable									

* Pb containing terminations are not RoHS compliant, exemptions may apply



DIMENSIONS in inches [millimeters]

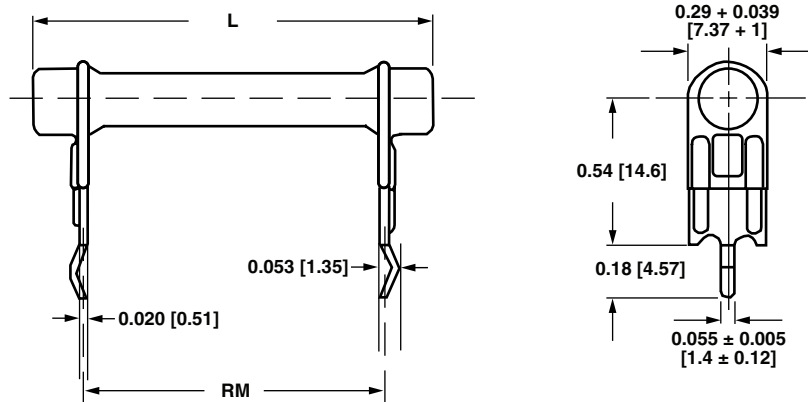

MODEL	DIMENSIONS in inches [millimeters]	
	L	RM
CPS04	0.945 ± 0.055 [24 ± 1.4]	0.598 [15.2]
CPS05	1.350 ± 0.055 [34.3 ± 1.4]	1.000 [25.4]
CPS07	1.752 ± 0.055 [44.5 ± 1.4]	1.398 [35.5]

SURFACE TEMPERATURE

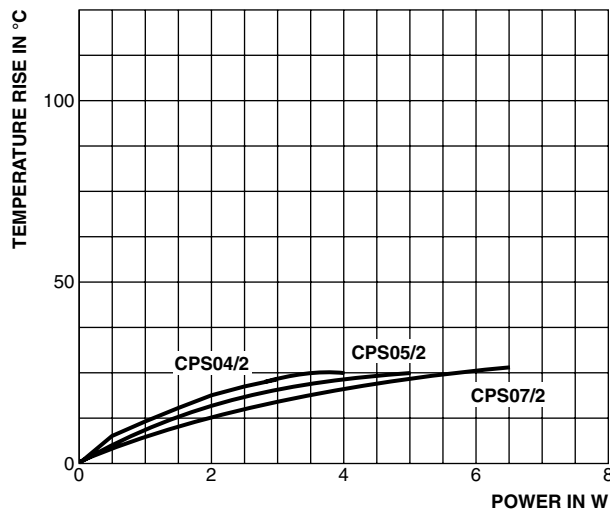
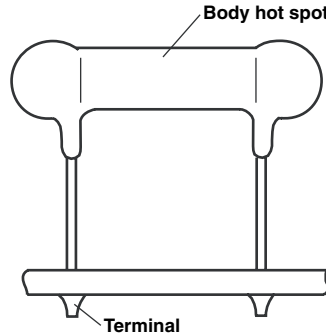

CPS Terminal Temperature

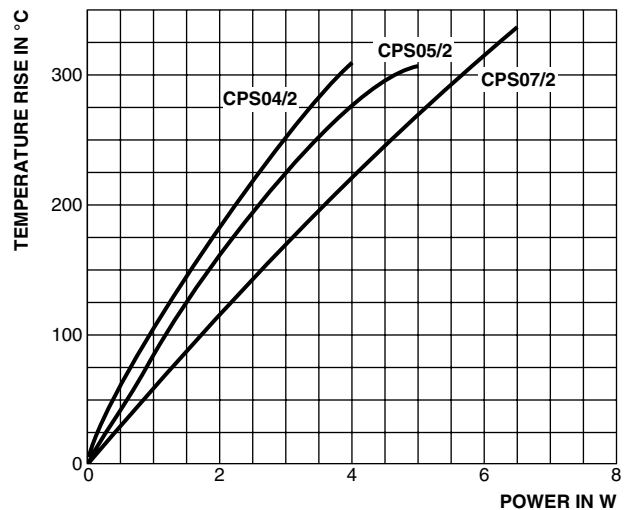

CPS Body Hot Spot Temperature Rise



Disclaimer

All product specifications and data are subject to change without notice.

Vishay Intertechnology, Inc., its affiliates, agents, and employees, and all persons acting on its or their behalf (collectively, "Vishay"), disclaim any and all liability for any errors, inaccuracies or incompleteness contained herein or in any other disclosure relating to any product.

Vishay disclaims any and all liability arising out of the use or application of any product described herein or of any information provided herein to the maximum extent permitted by law. The product specifications do not expand or otherwise modify Vishay's terms and conditions of purchase, including but not limited to the warranty expressed therein, which apply to these products.

No license, express or implied, by estoppel or otherwise, to any intellectual property rights is granted by this document or by any conduct of Vishay.

The products shown herein are not designed for use in medical, life-saving, or life-sustaining applications unless otherwise expressly indicated. Customers using or selling Vishay products not expressly indicated for use in such applications do so entirely at their own risk and agree to fully indemnify Vishay for any damages arising or resulting from such use or sale. Please contact authorized Vishay personnel to obtain written terms and conditions regarding products designed for such applications.

Product names and markings noted herein may be trademarks of their respective owners.